

Using a t-tap connector, connect the black -12V (negative) ground wire from the driver side mirror with the black -12V ground wire running to the driver side front marker light on the vehicle's light kit wire harness.

Using a t-tap connector, connect the red +12V (positive) wire from the driver side mirror with the yellow +12V wire running to the driver side front marker light on the vehicle's light kit wire harness.

Repeat this step to connect the passenger side mirror to the passenger side marker light wires. On RHOX light kits, the positive passenger side marker light wire will be green.

T-Tap Connector Installation:

Use pliers to close connector in Step 2.

The connectors will self tap into the wire mid-span without cutting or splicing the wire.

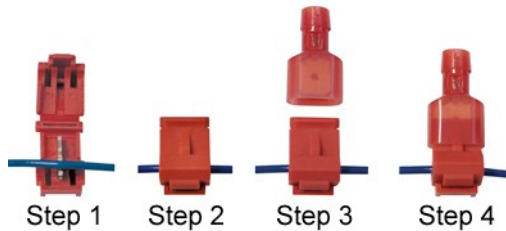

NOTE: The mirrors are designed for 12V operation only. Connecting the mirrors to a voltage higher than 12V will damage the mirrors and void any and all warranties.

MIRROR ADJUSTMENT NOTE: If adjusting the mirror do NOT over tighten the adjustment nut. Doing so may damage the wires.

14. Reconnect the system's positive and negative connections to the battery or battery pack once all lights and optional accessories have been installed.
15. Put the vehicle in the RUN position (if applicable) and turn the key ON. Use the turn signal to test the function of the mirrors.



Your Mirrors are now complete.
Please enjoy your vehicle safely!

Watch this installation and others on YouTube:
www.youtube.com/user/GolfCartInstructions



**ACC-1022
Side Mirrors
with LED Indicators
Installation Instructions**

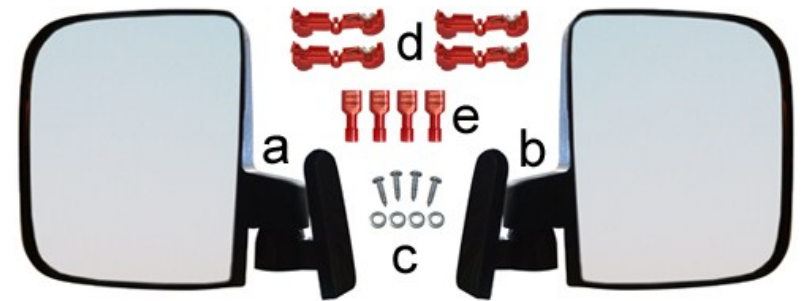

Contents of ACC-1022 Side Mirror Kit:

- a (1 ea.) Driver Side Mirror
- b (1 ea.) Passenger Side Mirror
- c (1 ea.) Bag of Mounting Hardware
- d (4 ea.) T-Tap Wire Connectors
- e (4 ea.) Spade Connectors
- f (1 ea.) Installation Instructions

Caution: Please read through the instructions carefully. Before starting this project, remove the system's positive and negative connections from the battery or battery pack. This kit is designed for a 12V operation only. Operating this kit at a higher voltage will void any and all warranties. Look behind each drill location BEFORE YOU DRILL. Installer is responsible for damage (i.e. drilling into a wiring harness, battery, fuel tank etc.).

Tools Needed for Installation

- Drill and Drill Bits (1/8", 3/8")
- Philips Head Screwdriver
- Fish Tape or Similar Tool
- Measuring Tape
- Thin Round File or Sand Paper
- Pliers

Before You Start

1. Turn the key to the OFF position.
2. Electric Vehicles Only: If your vehicle has a TOW/RUN switch, place it in the TOW position.
3. Engage the parking brake.
4. Remove the system's positive and negative connections from the battery or battery pack.

Mirror Installation

1. Hold the driver side mirror to the outside of the driver side front strut to identify the best mounting location for the driver.

NOTE: If installing a windshield, keep in mind the placement of the windshield when selecting a mounting location for the mirror.



2. With the mirror in the correct position, use a marking device to mark the location of the mounting holes on the driver side front strut. Set the mirror in a safe location.



3. Use an 1/8" drill bit to drill the top and bottom marked hole locations on the driver side strut. Do NOT drill completely through the strut. Only drill through the first wall.
4. To conceal the wire in the strut, follow Steps 5-8.
5. Use a tape measure and a marking device to mark a third hole location 3/4" above the bottom hole.
6. Use a 3/8" drill bit to drill a hole at the marked location. Do NOT drill completely through the strut. Only drill through the first wall. File or sand any rough edges.

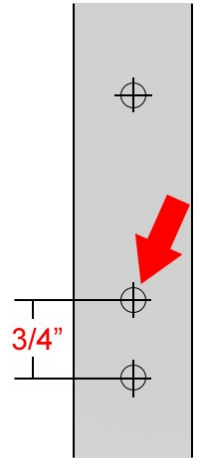

7. Access the bottom opening in the driver side front strut. This will vary depending on the vehicle
8. Using fish tape or a similar tool, carefully run the wires on the driver side mirror through the 3/8" hole in the strut to the opening in the bottom of the strut.

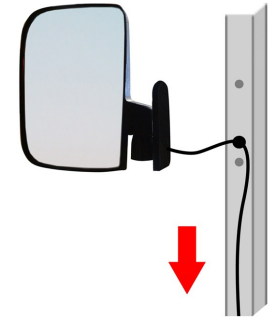

9. Use the included mounting hardware to mount the mirror to the strut. Do not over tighten the mounting screws.
10. Repeat steps 1-9 for the passenger side mirror.
11. Run the wires from both mirrors to the vehicle's wire harness.
12. Crimp a spade connector to each of the mirror's wires, (4) total.
13. Locate the wires running to the driver side front marker light on the vehicle's light kit wire harness.



NOTE: Wire colors listed below match RHOX light kits. The wire colors may vary with other brands.